

Rev No	Revision note	Date	Signature	Checked
A/0				

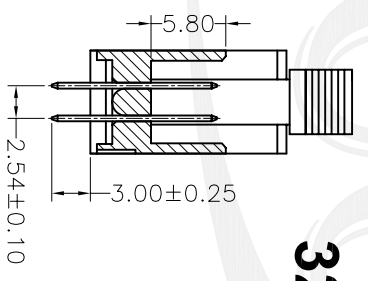
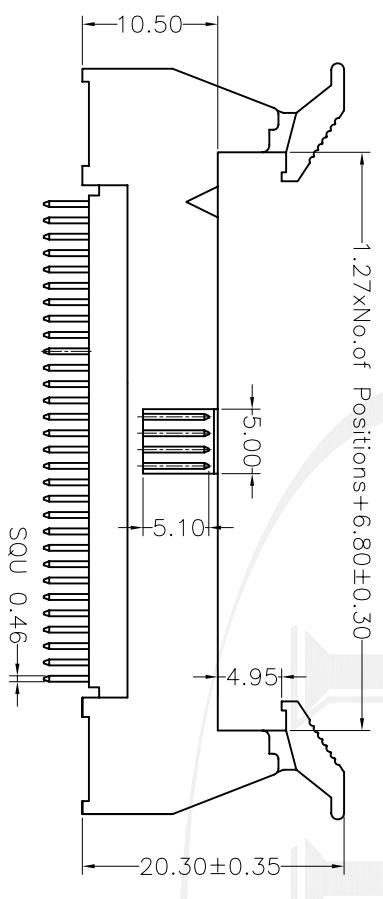
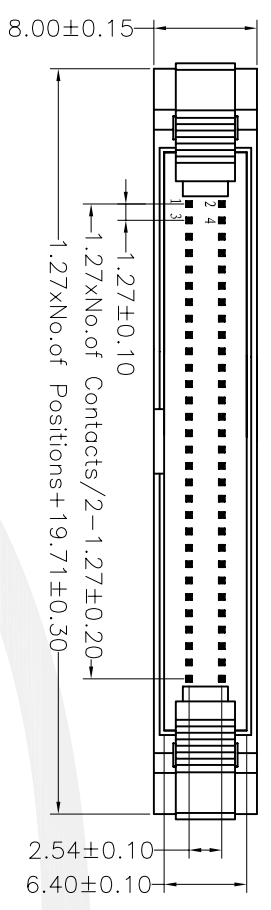

3240-XX S XX XS12

NO. of Pins	Contact Plating	Color Insulator
10=10P 12=12P 14=14P 16=16P 20=20P 24=24P 26=26P 30=30P 32=32P 34=34P 40=40P 44=44P 50=50P 60=60P 64=64P 80=80P 100=100P	G0=Gold Flash G1=3u" Gold G2=5u" Gold G3=10u" Gold G4=15u" Gold G5=30u" Gold S0=Gold Flash/Tin SN=Tin	B=Black W=White U=Blue R=Red Y=Yellow G=Grey

NOTES:
SPECIFICATION
 Current Rating: 1.0Ampereper Contact
 Contact Resistance: 20Milliohms Max
 Insulation Resistance: 1000Megohms Min
 Dielectric Withstanding Voltage: 500V AC(for 1 minute)
 Operation Temperature: -40°C~+105°C

Material
 Contact Material: Brass
 Contact Plating: Au or Sn Over Ni
 Insulator Material: Glass Filled Polyester(UL94V-0)
 Standard: Nylon-6T

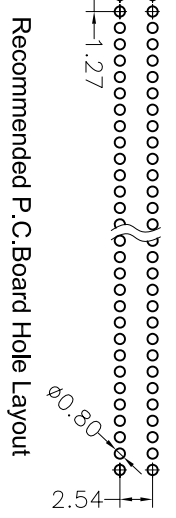

THIS DRAWING IS A CONTROLLED DOCUMENT			
DMN	JACK	DATE	OCT 05, 2006
CHK	MIKE	DATE	OCT 05, 2006
APPD	PETER	DATE	OCT 05, 2006
TOLERANCES UNLESS OTHERWISE SPECIFIED			
0 PLG	±		
1 PLG	±	0.20	
3 PLG	±	0.25	
4 PLG	±	0.30	
ANGLES ± 3°			
CAGE CODE	00871	FILE PATH	
YTCO YTCO TECHNOLOGY		HTTP://WWW.YTCO.CO	
TITLE		1.27x2.54mmEjectorHeader, StraightDIP	
PART NO.		3240-XXSXXS12	
DRAWING NO.		YT-3240S1	
SCALE	1:1	SIZE	A4
UNITS	MM		
SHEET	1 OF 1	REV	A